

CPI CABO DA AREA
EDUCACIÓN PLÁSTICA E VISUAL
3º ESO BILINGUAL

GEOMETRY

BY MARINA VÁZQUEZ LEMA

02/14/13

<#>



VILLA ROTONDA – ANDREA PALLADIO

<#>

The house is made of marble and stone on the stairs of each side. It has statues on the walls of the stairs and also on the roof. It also has a lot of windows on the walls. In the entrances it has a structure with columns like a Greek temple. The architectural style of the house is neoclassic.

Andrea Palladio was born in Padua (Italy) in 1508 and he died in Maser (Italy) in 1580. He worked fundamentally in the town of Venice. He was one of the influential people of neoclassicism.

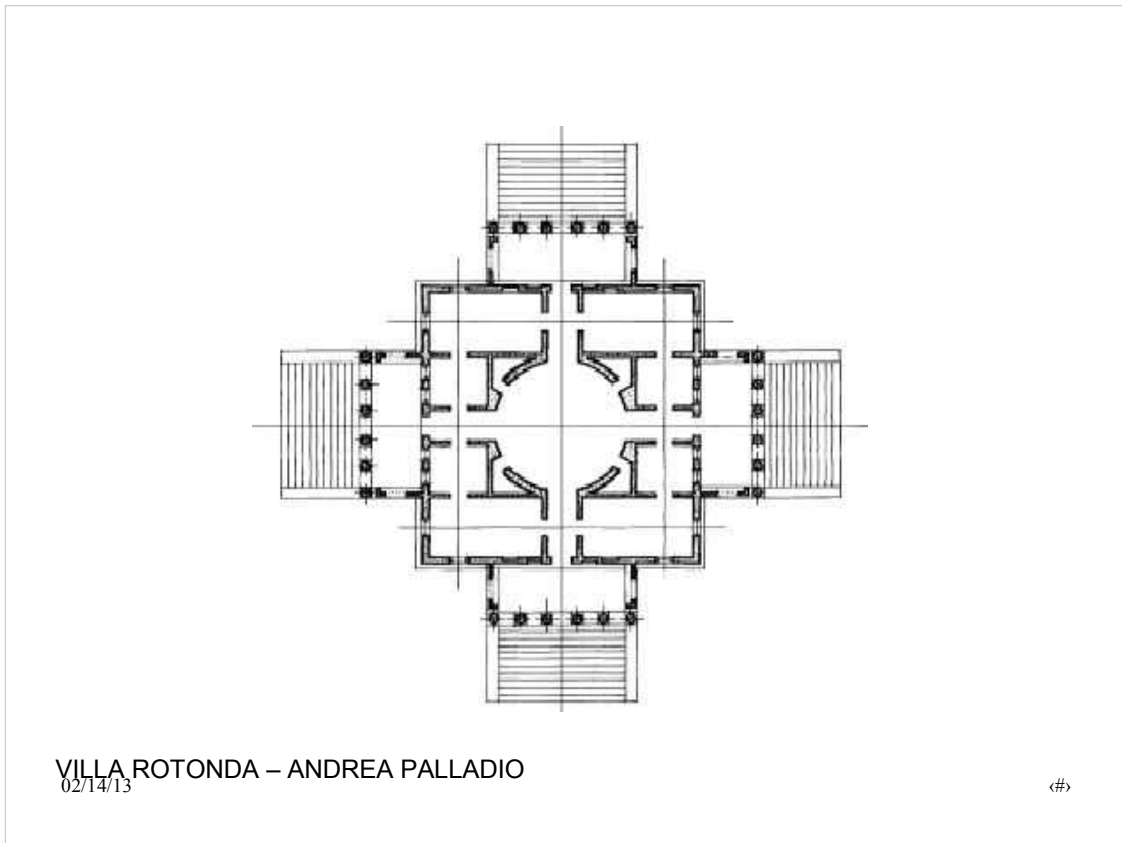

This is the floor plan. It has 4 stairs. It also has 4 entrances. The base structure of the house is a square. Each side has a square-shaped stair. In the middle of the base structure it has a circle divided in four equal parts. The rooms of the house are rectangles, squares and triangles. The plan of this house shows two symmetric parts.



VILLA SABOYE – LE CORBUSIER

02/14/13

<#>

The base of this house is a rectangle. In the roof there is a platform with a semicircle joined to a square. On the second floor there are windows in a line. The columns support the second floor.

It is in the modern style . It is located in Poissy, France.

The architect is Le corbusier who was one of the pioneers of modern architecture. He was born in Switzerland.



02/14/13
VILLA SAVOYE – LE CORBUSIER

<#>

In this side of the house there are two lines of windows on the second floor. On the first floor there is a gap.

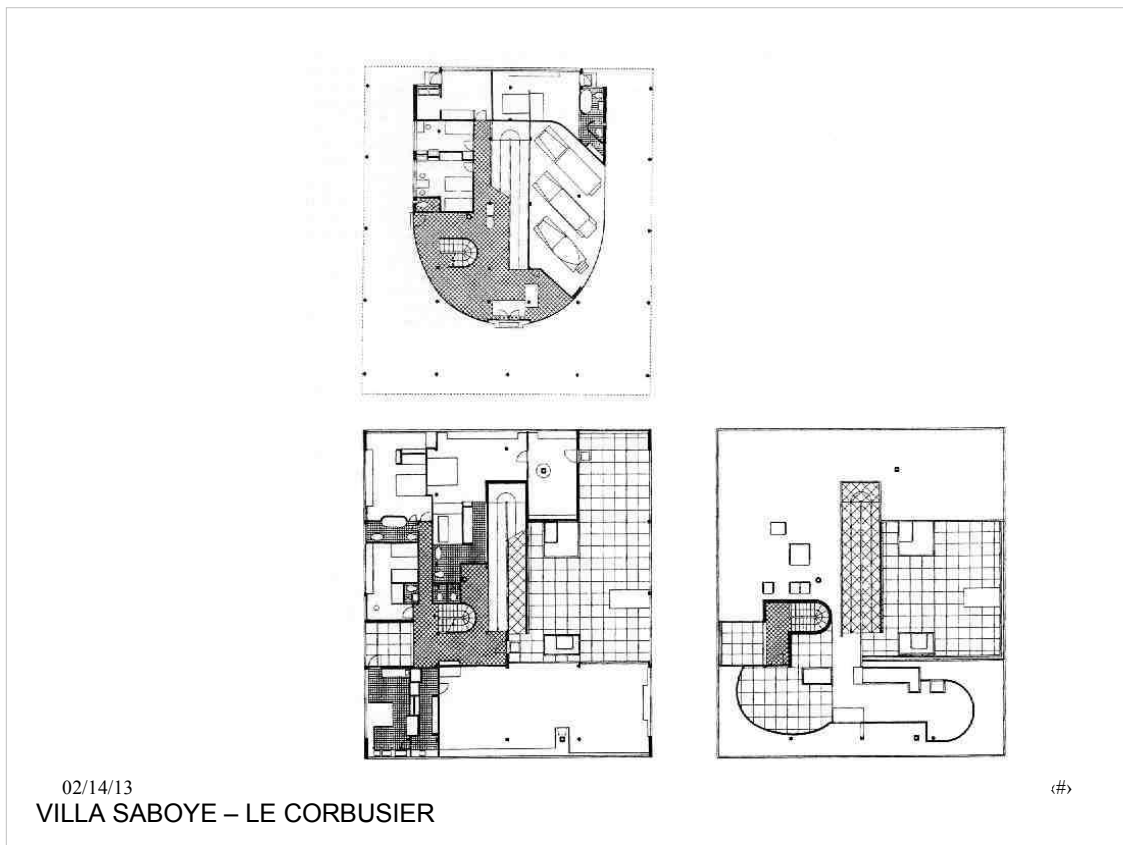

The plans of this house are very interesting because on two floors there aren't rectangles like second floor. The third floor looks like a semicircle and the first floor is a very strange shape because there are three semicircles, two squares and one rectangle.



02/14/13
WATERFALL HOUSE – FRANK LLOYD WRIGHT

<#>

This house is very shocking because it is in a waterfall.

In one of the sides of the construction there is a fire escape. The walls of the house are rectangles in a lot of dimensions.

Some walls are bricks like stone and the rest look like cement or concrete painting.

He was born in Wisconsin (USA). He was an architect in 20th century. He became famous for his organic architecture and his designs.



02 EDUARDO CHILLIDA

<#>

This sculpture has rectangular form. There are something like cracks in the rectangle. They have different geometric forms. The material looks like marble.



This sculpture is a structure of rectangles and some forms look like horseshoes.

It looks like the letter “T” and in the end of one of the parts of the structure there are some horseshoes.

It was made in metal and it looks rusty.

Eduardo Chillida was born in San Sebastián(Spain).

He was a Spanish sculptor.

He was a football player in the Real Sociedad of San Sebastián.

He studied in Madrid and he has a museum, Chillida-Leku located at Hernani.

I don't like his sculptures very much because I don't understand the meaning of his monuments.

(note: All this sculptures represent evolution: how branches, which come from the same parent, take their own shape)

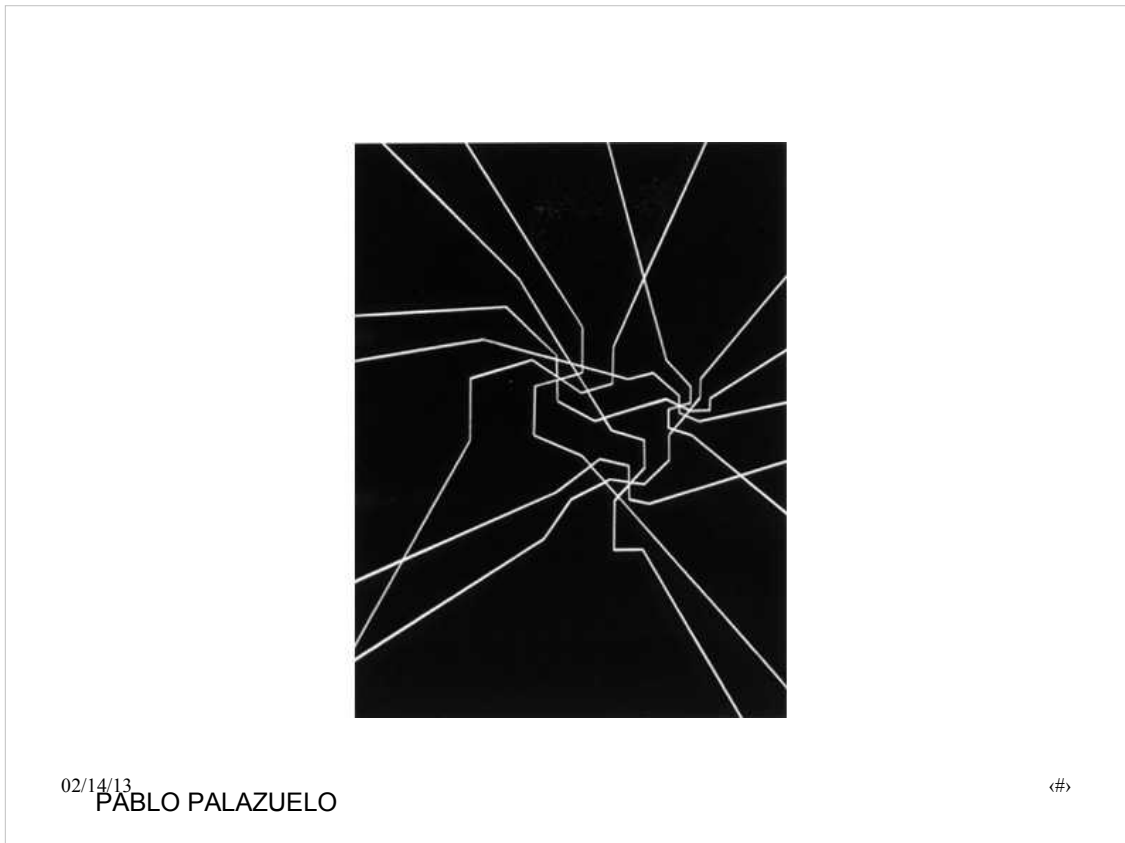

In this picture there are a lot of white lines crossing the black background.
All the lines construct geometric forms in the middle of the picture.
There aren't any curvaceous lines.



This picture is similar to the other. It has white lines on a black background. The difference is the position and the form of the lines. The lines are vertical going in different orientations.

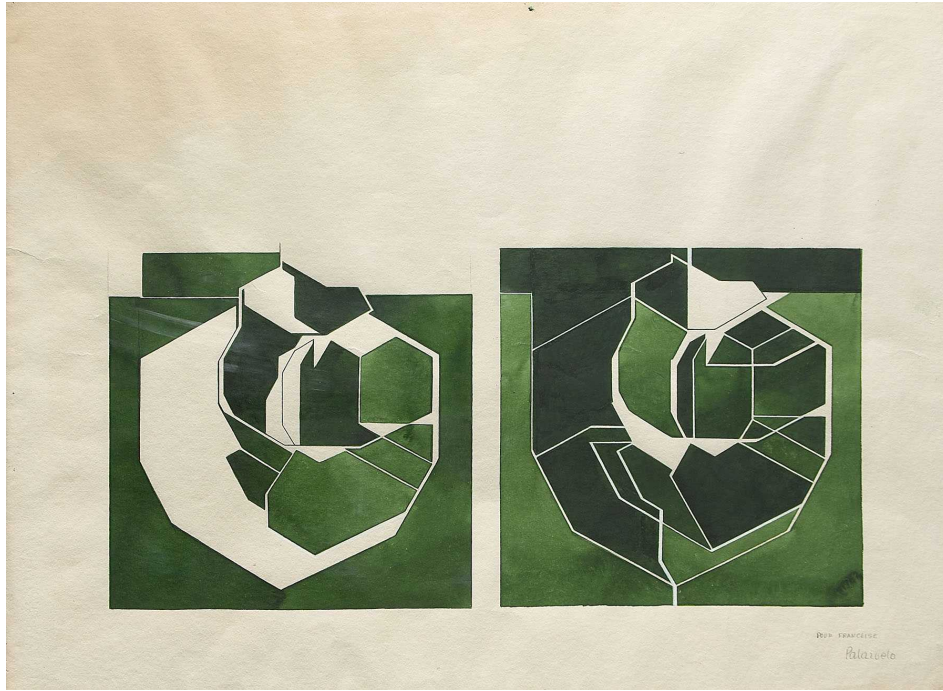

PABLO PALAZUELO
02/14/13

<#>

In this picture there are two images of the same object painted in a different way. It's painted in shades of green.

The forms inside the figure are made of irregular polygons.

In the two pictures the polygons inside are all different



imagen obtenida de www.fernandoduran.com

Lote: 137

PABLO PALAZUELO

02/14/13

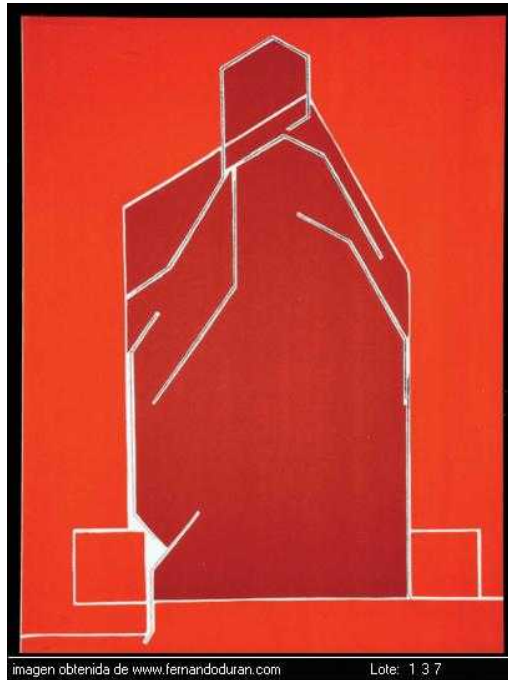
<#>

In this picture there is a red background and white lines that make polygons .

There are two squares in the sides of the central poligon. This is an irregular pentagon joined to an other irregular pentagon on the top of the picture.

There are two shades of red: one more dark red in the central polygon and another more bright in the rest of the picture.



PABLO PALAZUELO
02/14/13

<#>

In this other picture there are a lot of polygons in different colors.

Almost all the polygons are parallelograms with four or five sides.

The colors of the picture are muted. The dark shades of the picture give the impression of depth.



PABLO PALAZUELO
02/14/13

<#>

In this picture we can see polygons and lines in two colors. There are different polygons. In the picture we can see three principal polygons in the centre of the image.

Pablo Palazuelo was born in Spain in 1951. He was an architect, he studied in Madrid and in London.

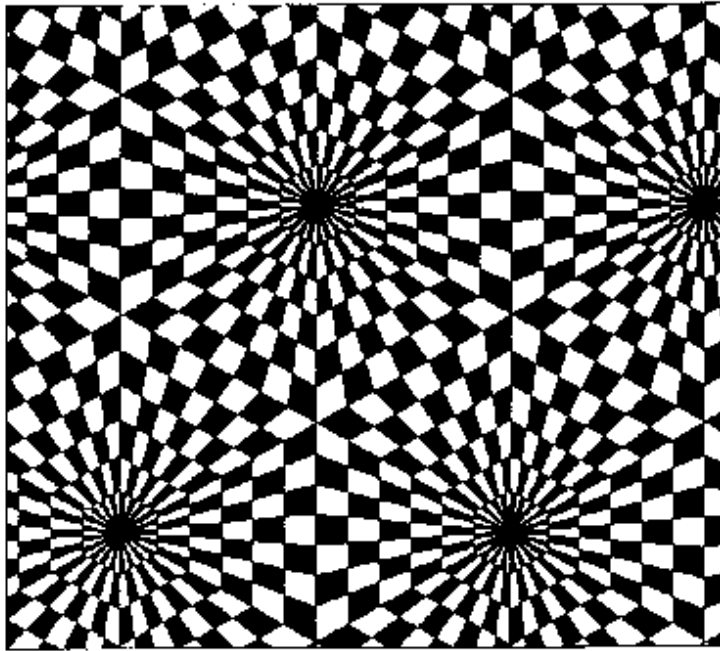

© 1967 Victor Vasarely, All Rights Reserved. Dover Publications.

02/14/13 VICTOR VASARELY

<#>

In this picture we can see four hexagons circled with more hexagons formed of rectangles in different positions. When someone sees this, they feel was the sensation of depth. The picture only has two colors: black and white, this is the other factor of the sensation of depth.

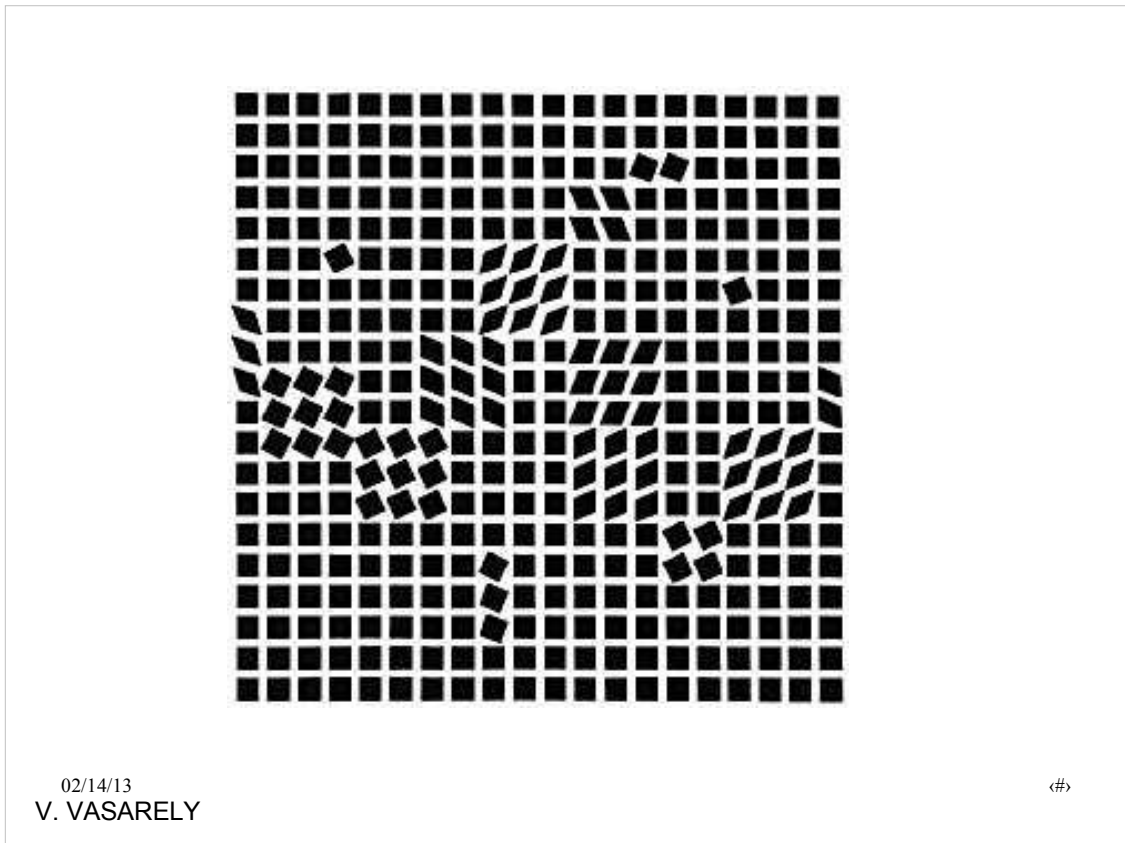

This other picture is a grid in the color black. Some squares of the grid are distorted. This time the sensation is of relief.

The little squares are in the same position but go in different directions.



02/14/13
V. VASARELY

<#>

In this image there are octagons in different positions and different colors. The dark colors give the sensation of depth and the light colors oppose the sensation.

Victor Vasarely was born in Hungary in 1906. He studied in Budapest at the Abstract Art School. In France in 1997 he died.